

ELI 250 N BT

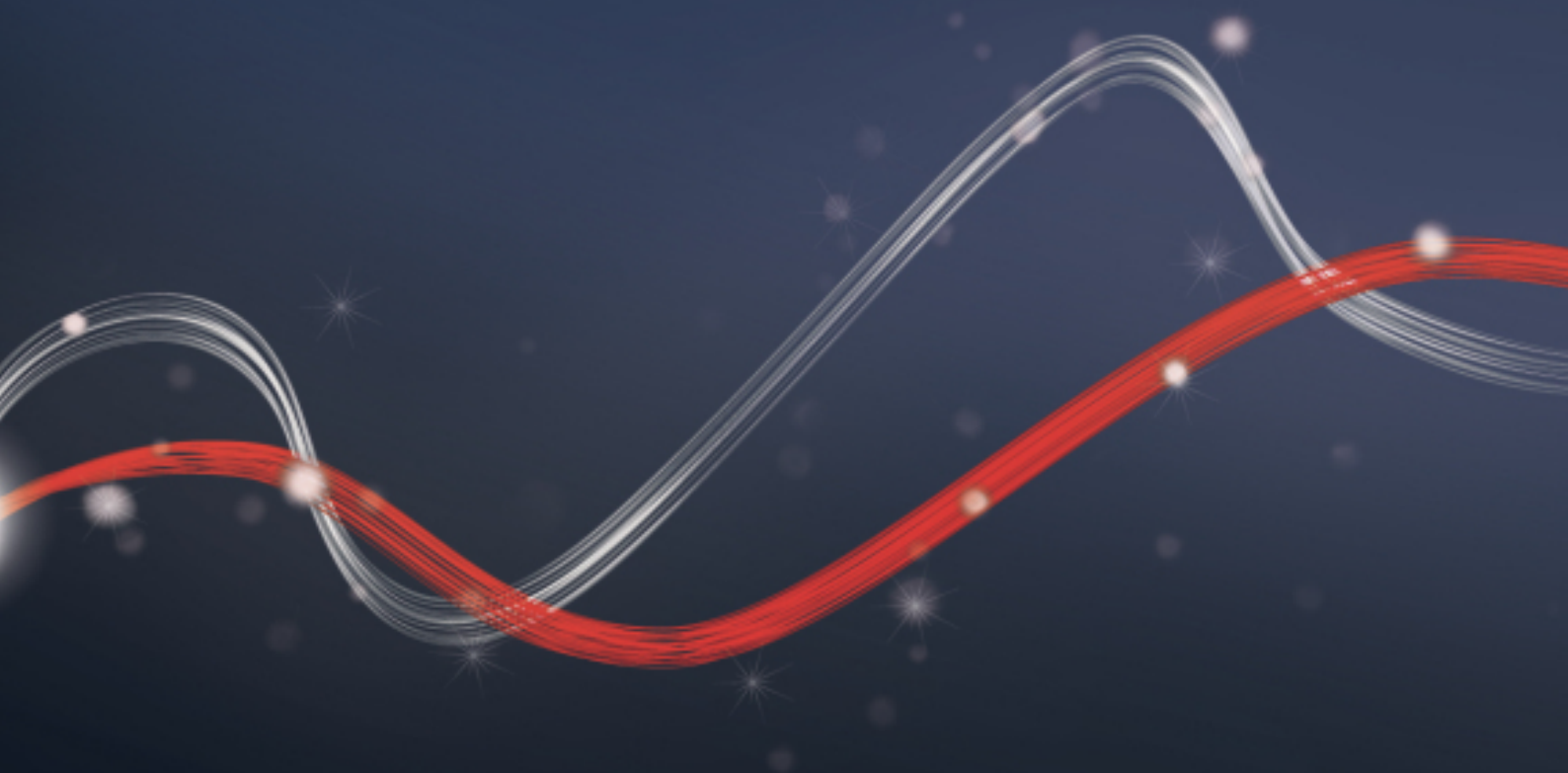

- Product

- CONTROL UNIT
- TECHNICAL FEATURES

- ACCESSORIES

- DISCOVER U-LINK



ee link



24 V



er ready



d-track



U-Link



Empowered by
U-LINK

Complete range of irreversible underground electromechanical operators for swing gates up to 400 kg and 3.5 m long.

ELI 250 N BT | | | | | |

Code	Name	Description
P930125 00001	ELI 250 N BT	In-ground irreversible electromechanical operator 24 V for swing gates weighing up to 400 kg and 3.5 m long.



U-Link

· Product

· **CONTROL UNIT**
· **TECHNICAL FEATURES**

· ACCESSORIES

· **DISCOVER U-LINK****THALIA D113745 00002 Built-In****Control panel with display for one or two 24V electromechanical operators for swing gates**

- Board power supply: 230V single-phase
- Operators power supply: 24Vdc 180W max each operator
- Main functions: automatic re-closing, fast closing, partial opening, deadman feature
- Compatibility: LIBRA C MA, LIBRA, LIBRA R, LIBRA MA R

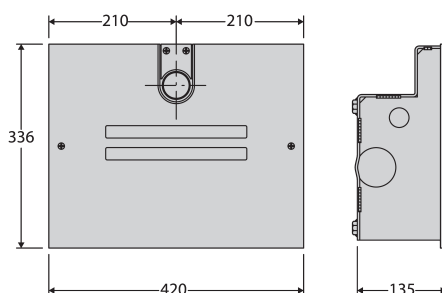

	ELI 250 N BT
Control unit	THALIA
Power supply	24 V
Power input	175 W
Maximum angle	120 °
Cycle time	15 sec
Type of limit switch	magnetic
Slowdown	yes
Locking	mechanical
Release	lever or lever with personalised key
Frequency of use	intensive
Environmental conditions	from -20 °C to 50 °C
Protection rating	IP67
Operator weight	10 kg
Impact reaction	d-track
Operator type	swing gates with underground electromechanical operator

• Product

• CONTROL UNIT
• TECHNICAL FEATURES

• **ACCESSORIES**

• DISCOVER U-LINK













	Code	Name	Description
	D113745 00002	THALIA	Control panel with display for one or two 24V electromechanical operators for swing gates
	D113747 00002	THALIA P	Control panel for one or two 24V electromechanical and hydraulic operators for swing gates with electric lock management, for highly complex systems
	D831081	CMS	Sign
	N190104	BIR C	Rubber safety edge (H 30 mm), price per m
	N733397	BTCF 120 E	Foundation box with levers for ELI 250 N BT, ELI 250 N, ELI 250 N V. Without BTCF 120 E release
	N733398	BTCF 120 E INOX	Stainless steel foundation box with levers. Without release, (as an alternative to BTCF 120 E)
	N733392	SCC	Releases for ELI250 with SCC lever spanner
	N733502	SCP	Release for ELI 250 and SUB BT with personalized key.
	D121016	ECB DX	Right-hand horizontal solenoid lock, 12-24V
	D121017	ECB SX	Left-hand horizontal solenoid lock, 12-24V
	D121018	ECB VERTICALE	Vertical solenoid lock, 12-24V
	P123001 00001	EBP	EBP 230Vac electric drop lock
	P123006 00001	EBPE 52	230Vac solenoid lock with zero stop resistance, also with release from outside for gates of max thickness 50 mm
	P123008 00001	EBPE 75	230Vac solenoid lock with zero stop resistance, also with release from outside for gates of max thickness 75 mm
	P123001 00013	EBP 24	24Vac solenoid lock, with 230/24V transformer installable in control panel

· Product

· CONTROL UNIT
· TECHNICAL FEATURES

· ACCESSORIES

· DISCOVER U-LINK

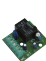
	Code	Name		Description
	D113749 00003	RADIUS B LTA 24 R2		Flashing light without incorporated antenna for motors with power supply 24 V.
	D113748 00003	RADIUS B LTA 24 R1		Flashing light with incorporated antenna for motors with power supply 24 V.
	P123025	B 00 R02		Wall mounting for B LTA series flashing beacons
	D111904	MITTO B RCB02 R1		Transmitter with 2 channels. Range 50/100 m. Power supply 12 V with 1 battery type 23 A
	P123026	B 00 R01		Metal guard for B LTA
	P121024	Q.BO TOUCH		Wireless digital touchpad with 433MHz rolling code operation. Manages up to 10 channels and 100 codes.
	P121022	Q.BO KEY WM		Key selector for outdoor use with double contact.
	P111526	DESME A15		Pair of self-aligning photocells. Range 30 m. Power supply 24 V ac/dc. Pair of self-aligning photocells. Range 30 m. Power supply 24 V ac/dc.
	P903018	PHP		Pair of aluminium posts for THEA/DESME series photocells Height 522 mm
	P125020	BBT BAT		Set of backup batteries for THALIA and THALIA P
	D111761	ME BT		Control board for 24Vac solenoid lock for 24V automation systems

· Product

· CONTROL UNIT
· TECHNICAL FEATURES

· ACCESSORIES

· DISCOVER U-LINK

What is U-Link?

The innovative technology that gives you new power

An exclusive Bft innovation: U-Link (Universal Link) is an exclusive Bft platform that allows the creation of technological ecosystems. In Home Automation Access, it allows communication with all the home access automation devices of any brand. So you save time and can control everything with ease, without any worries.

It is intuitive

Easy to install and use

It is scalable

Allows an unlimited number of devices to be added

It is flexible

Allows the creation of groups of interconnected products

It is practical

Works with or without a web connection

It is functional

Parameters can be controlled remotely via dedicated applications

• Product

• CONTROL UNIT
• TECHNICAL FEATURES

• ACCESSORIES

• DISCOVER U-LINK

All in one scheme: discover this amazing technology

A unique platform **allowing the creation of technological ecosystems** offering a wide range of solutions for different sectors.

Thanks to the B-Eba cards and the Clonix U-Link receiver, this proprietary platform featured by Bft products adapts to any protocol and access automation product (even BFT, non-native U-Link or non-BFT products), and is used in various sectors. Each device thus becomes smart and can be interconnected with other systems, thanks to a language that becomes universal.

U-Base 2



Software to install and easily and comfortably carry out maintenance and identify any malfunction of U-link compatible operators.

U-SDK



U-SDK is the innovative application that can make Bft automation systems compatible and easily integrated with a BMS network for the supervision of buildings.



Magistro

An innovative and easy to install system for easily managing all home automation systems.



U-Control

U-Control is the application that helps the quick and easy integration of BFT automation systems in large building management systems.



Blue-Entry

Technology abreast of the times and attentive to daily needs: thanks to the use of U-link the house gate can now be opened with just your smartphone.



Clonix U-Link

Allows the connection of non-native U-Link products or non-Bft products to U-Link systems.

Bft operators, non-native U-Link products or a product belonging to other brands: can they be connected to U-Link? Yes, thanks to the Clonix receivers. Accessories that know no limits.



B-Eba

A direct line with your operators.

B-Eba expansion cards allow the connection of external devices, such as PCs, smartphones and tablets, to a Bft operator or Clonix receiver, or the connection of several Bft products in a U-Link network. These accessories integrate with U-Link technology and Bluetooth, Z-Wave, TCP/IP protocols, as well as the RS485 serial connection.

A device that fully translates what Bft means for interconnectivity.

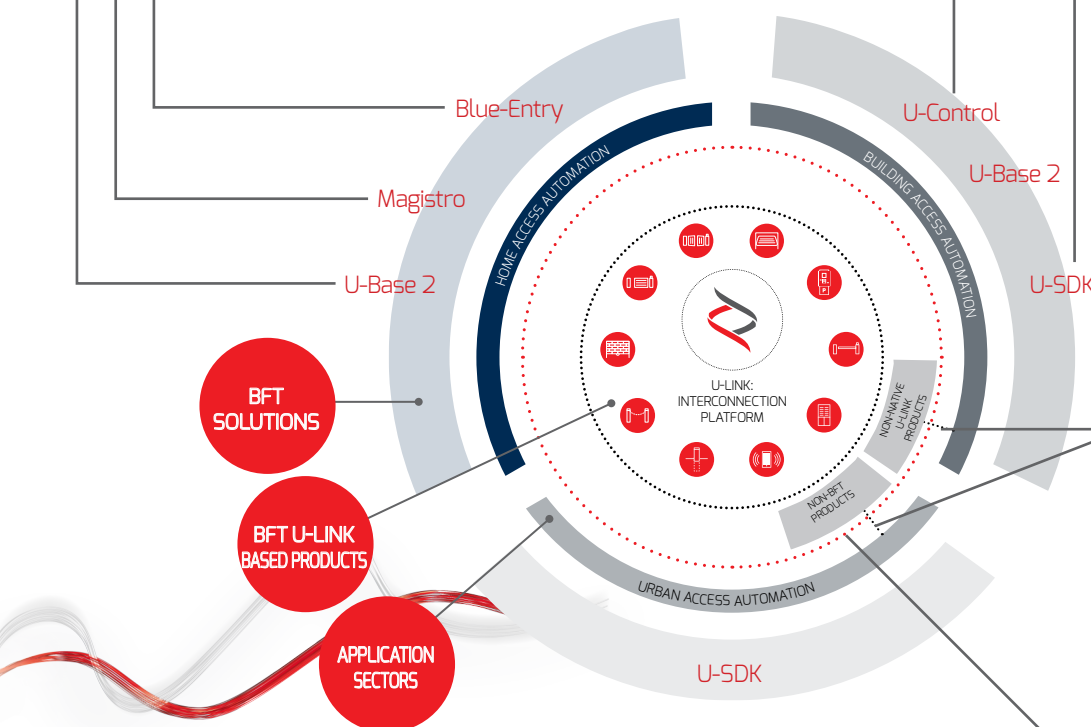



INFORMATION REGARDING THE PROTECTION OF THE INDUSTRIAL AND INTELLECTUAL PROPERTY RIGHTS OF BFT. BFT S.p.A. protects its industrial property by depositing trademarks, patents, models and designs. The intellectual property of BFT S.p.A. is protected by copyright law. BFT S.p.A. also protects its know-how by taking measures to protect the technical and commercial information inherent in its company and products. All the products in this catalogue are ORIGINAL BFT MODELS and only BFT S.p.A. is authorised to produce them and market them anywhere in the world. All the commercial names in this catalogue are owned by BFT S.p.A., and only BFT S.p.A. is authorised to use them in relation to the corresponding merchandise category. FALSIFIERS WILL BE PROCEEDED AGAINST IN ACCORDANCE WITH BOTH CIVIL AND CRIMINAL LAW. THESE CONDITIONS NOT ONLY GUARANTEE THE INTELLECTUAL PROPERTY RIGHTS OF BFT, BUT ALSO PROTECT CUSTOMERS BY GUARANTEEING THAT THE PRODUCTS THEY ARE PURCHASING ARE ORIGINAL BFT PRODUCTS RESULTING FROM STUDIES AND DESIGNS WITHIN THE BFT COMPANY.